

Project	Quantity	Item #
Model Specified:		CSI Section 11400

Compact Undercounter Refrigerator Models Self-Contained R290



Model Shown: UHT27R0-0300



27", 32", 48", 60 & 72" Wide Models

27" One Door Refrigerator Hinged Left	UHT27L0-0300
27" One Door Refrigerator Hinged Right	UHT27R0-0300
32" One Door Refrigerator Hinged Left	UHT32L0-0300
32" One Door Refrigerator Hinged Right	UHT32R0-0300
48" Two Door Refrigerator Hinged Left/Right	UHT48LR-0300
48" Two Door Refrigerator Hinged Left/Left	UHT48LL-0300
48" Two Door Refrigerator Hinged Right/Right	UHT48RR-0300
60" Two Door Refrigerator Hinged Left/Right	UHT60LR-0300
60" Two Door Refrigerator Hinged Left/Left	UHT60LL-0300
60" Two Door Refrigerator Hinged Right/Right	UHT60RR-0300
72" Two Door Refrigerator Hinged Left/Right	UHT72LR-0300
72" Two Door Refrigerator Hinged Left/Left	UHT72LL-0300
72" Two Door Refrigerator Hinged Right/Right	UHT72RR-0300

Traulsen is proud to offer the North American market a broad selection of self-contained reach in and compact undercounter refrigeration with R290, a natural recurring refrigerant with a GWP of (3), the lowest currently available in our industry. We are committed to reducing global warming potential (GWP) and saving energy consumption while maintaining the performance and quality you have come to expect from Traulsen products.

Standard Product Features

- Stainless Steel Exterior Top, Sides & Doors
- Anodized Aluminum Interior
- Front Breathing Self-Contained Refrigeration System
- Environmentally Friendly R290 Refrigerant
- Self-Closing Stainless Steel Doors With Stay Open Feature At 105 Degrees
- Anodized Aluminum Interior Door Liner
- Interior Mounted Thermometer
- Two (2) Powder Coated Shelves Per Door, Mounted On Pilasters
- Automatic Non-Electric Condensate Evaporator
- Magnetic Snap-In EZ-Clean Door Gasket(s)
- 8' Cord & Plug Attached
- Set of Four (4) 4" High Casters (6 For 60" & 72" models)
- Three Year Parts And Labor Warranty
- Five Year Compressor Warranty



Sustainability Features

- SNAP compliant R290 (GWP 3) Refrigerant EPA Rule 20
- All Metal Construction And Long Equipment Life Reduces Pressure On Landfills
- Real World Energy Efficiency Helps Reduce Fossil Fuel Emissions

Optional Accessory Kits*

- **CASTER 5SET4** (four 6" high casters for 27", 32" & 48" models)
- **CASTER 5SET6** (six 6" high casters for 60" & 72" models)
- **CASTER SET3IN** (four 3-1/2" high casters for 27", 32" & 48" models)
- **CASTER SET4** (six 3-1/2" high casters for 60" & 72" models)
- **CASTER SET2IN** (four 2-1/2" high casters for 27" & 32" models)
- **CASTER 2SET4** (four 2-3/4" high casters for 48" models)
- **CASTER 2SET6** (six 2-3/4" high casters for 60" & 72" models)
- **SHELF CPW1** (additional shelf for all 27" models)
- **SHELF CPW2** (additional shelf for all 32" models)
- **SHELF48 UPPER** (upper shelf for all 48" models)
- **SHELF48 LOWER** (lower shelf for all 48" models)
- **SHELF60 UPPER** (upper shelf for all 60" models)
- **SHELF60 LOWER** (lower shelf for all 60" models)
- **SHELF72 UPPER** (upper shelf for all 72" models)
- **SHELF72 LOWER** (lower shelf for all 72" models)
- **CU27TOP BSWO** (22 ga. stainless steel top with 4" backsplash UHT27)
- **CU32TOP BSWO** (22 ga. stainless steel top with 4" backsplash UHT32)
- **CU48TOP BSWO** (22 ga. stainless steel top with 4" backsplash UHT48)
- **CU60TOP BSWO** (22 ga. stainless steel top with 4" backsplash UHT60)
- **CU72TOP BSWO** (22 ga. stainless steel top with 4" backsplash UHT72)

*Optional accessory kits shipped separately for field installation.

Factory Installed Options

- Stainless Steel Finished Back
- Other Door Hingsings



This unit is listed to UL 471, CSA 120 and NSF 7 by an approved NRTL. Consult the factory or unit data plate for approval information.



Many Traulsen models are EPA Energy Star listed. Please refer to www.energystar.gov to view the most up-to-date product listing and performance data.

Approval: _____



TRAULSEN
4401 BLUE MOUND RD.
PHONE 1 (800) 825-8220
Website: www.traulsen.com

FT. WORTH, TX 76106
FAX-MKTG. 1 (817) 624-4302

Project	Quantity	Item #
Model Specified:		CSI Section 11400

Specifications

Construction, Hardware and Insulation

Cabinet exterior front, one piece sides, and doors are constructed of 22 gauge stainless steel. Cabinet interior and door liners are constructed of anodized aluminum. The exterior cabinet back and bottom are constructed of galvanized steel.

Door self close at less than 90 degrees and also include a stay open feature at 105 degrees. Gasket profile and Santoprene® material simplify cleaning and increase overall gasket life. Both the cabinet and door(s) are insulated with an average of 2" thick high density, non-CFC, foamed in place polyurethane.

Refrigeration System-R290

A balanced, rear mounted, front breathing, self-contained refrigeration system using R290 refrigerant is provided. It features a capillary tube metering device, air-cooled hermetic compressor, a forced air evaporator coil and a non-electric condensate evaporator. An 8' cord and plug is provided. Standard operating temperature for refrigerator models is 34° to 38°F.

Interior

Standard interior arrangements include two (2) powder coated wire shelves per door, mounted on pilasters. These are adjustable in 1/2" increments, allowing for a minimum of 1-1/2" spacing between shelves.

Warranties

Both a three year parts and labor warranty and a five year compressor warranty (self-contained models only) are provided standard.

Cabinet Dimensional Data								
Model	Storage cu. ft.	Width - cabinet	Width - door	Depth - door open 90°	Clear door opening	# of doors	# of shelves	Total shelf area sq. ft.
UHT27L0-0300								
UHT27R0-0300	7.1	27"	25 7/8"	55 3/8"	22 3/4"	1	2	4.88
UHT32L0-0300								
UHT32R0-0300	8.3	32"	30 13/16"	60 3/8"	27 3/4"	1	2	6.1
UHT48LR-0300	13.5	48"	21 1/8"	50 5/8"	18"	2	4	10.3
UHT60LR-0300	17.4	60"	25 7/8"	55 3/8"	22 3/4"	2	4	13.2
UHT72LR-0300	21.3	72"	30 13/16"	60 3/8"	27 3/4"	2	4	15.5

Electrical & Refrigeration Data			Shipping Data		
115/60/1 R290 NEMA 5-15P			(42"D x 41"H)		
Model	Full Load Amps	BTU/HR - HP	Width - crated	Volume - crated cu. ft.	Weight - lbs.
UHT27L0-0300					
UHT27R0-0300	7.2	1525 (1/4)	45"	45	240 net/275 gross
UHT32L0-0300					
UHT32R0-0300	7.2	1525 (1/4)	45"	45	255 net/300 gross
UHT48LR-0300	7.2	1525 (1/4)	69"	69	355 net/400 gross
UHT60LR-0300	7.2	1525 (1/4)	69"	69	457 net/500 gross
UHT72LR-0300	7.2	1525 (1/4)	84"	84	548 net/575 gross

NOTES:

- Based on a 90 degree F ambient and 20 degree F evaporator.
- When ordering please specify: voltage, hinging, optional accessories and any additional warranties.
- This unit may be manufactured in other electrical characteristics and may have additional regulatory agency approvals. Consult factory for other electrical characteristics and agency approvals based on specific electrical and country requirements. (For exact electrical information and approval marks, always refer to the data label of the unit.)
- Continued product development may necessitate specification changes without notice.

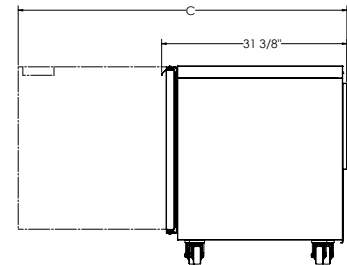
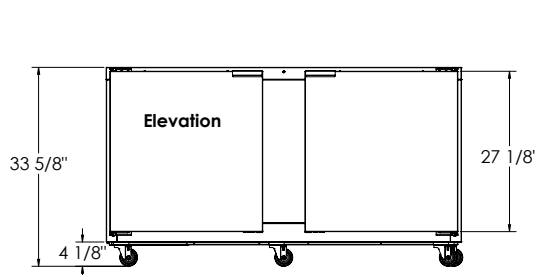
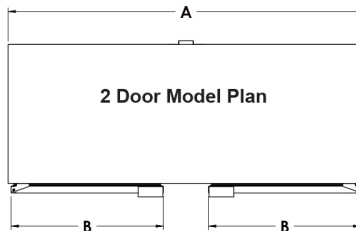
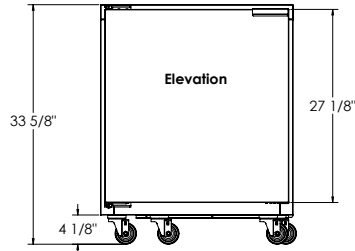

Part No. TR35971 (12-20-18)

TRAUlsen
4401 BLUE MOUND RD.
PHONE 1 (800) 825-8220
Website: www.traulsen.com

FT. WORTH, TX 76106
FAX-MKTG. 1 (817) 624-4302

Traulsen