



MBCB72



## MBCB SERIES

### Chef Bases

#### MODELS

- MBCB36
- MBCB48
- MBCB53
- MBCB60
- MBCB72
- MBCB84
- MBCB96

### FEATURES

#### CONSTRUCTION

- Designed to accommodate countertop cooking equipment
- Stainless steel top, front, sides and drip guard top
- Stainless steel interior
- Galvanized steel back and bottom
- Foamed-in-place with low ODP polyurethane insulation
- Wall thickness: 1.75"
- Top thickness: 2"
- Full marine drip guard to prevent spills from dripping over the edge (not applicable on MBCB36)
- Exterior digital thermometer
- 4" diameter casters
- Heavy-duty ergonomic handles

#### DRAWERS

- Stainless steel frames
- Supported on stainless steel

- telescoping drawer slides with stainless steel roller bearing wheels
- Drawer slides withstand maximum of 200 lbs. per drawer without deflection
- Upper and lower drawers accommodate 4" deep 12" x 20" pans
- Heavy-duty pan adapter bars supplied for full-size pans
- Pans not included
- Snap-in type vinyl magnetic gasket attached to each drawer for positive seal

#### REFRIGERATION

- Self-contained forced air refrigeration system metered by capillary tube
- Automatic defrost
- High humidity evaporator coils are coated to resist corrosion
- Removable front thermometer panel

and grille for easy access to slide-out refrigeration system

- Refrigerant: R290
- Temperature range: 35° to 40°F (1.7° to 4.4°C)

#### WARRANTY

- **Standard limited three year parts and labor**
- **Additional two year coverage on compressor part**

#### OPTIONS

- Full size stainless steel pans (4" x 20<sup>3</sup>/<sub>4</sub>" x 12<sup>3</sup>/<sub>4</sub>", 14 quart)
- Horizontal pan dividers (to accommodate 1/3 & 1/6 size pans)

### BID SPECIFICATIONS

Item no. MBCB\_\_\_\_\_. Provide \_\_\_\_\_ Chef Base(s), Master-Bilt® model no. MBCB\_\_\_\_\_.

Chef base will feature stainless steel top, front, sides & drip guard top. Interior will be stainless steel with galvanized steel back and bottom. Base will be equipped with a full marine drip guard (not applicable on MBCB36), an exterior digital thermometer,

and 4" diameter casters.

Drawers will feature stainless steel frames and will be supported on stainless steel telescoping drawer slides with stainless steel roller bearing wheels. Drawer slides to withstand maximum of 200 lbs. without deflection.

The refrigeration system will be self-contained forced air type. Refrigerant will

be R290. The temperature range will be 35° to 40°F (1.7° to 4.4°C). System will be equipped with automatic defrost and coated evaporator coils.

Chef base to have standard limited 3-year limited parts and labor warranty with additional 2-year coverage on compressor part.

Chef base to be UL, C-UL and ETL Sanitation listed.

### TECHNICAL SPECIFICATIONS

MODEL	DIMENSIONS (in.)			DIMENSIONS (mm)			VOLTS	AMPS	UNIT H.P.	NO. OF DRAWERS	NO. OF PANS**	CAP. CU. FT.	SHIP CU. FT.	SHIP WT. (LB/KG)
	L	D	H*	L	D	H*								
MBCB36	36	31	25 1/2	914	787	648	115	3.0	1/5	2	(2) full size, (4) 1/4 size	5.7	20.0	181/82
MBCB48	48	31	25 1/2	1219	787	648	115	3.0	1/5	2	(4) full size, (4) 1/4 size	8.2	27.0	220/100
MBCB53	53	31	25 1/2	1340	787	648	115	3.0	1/5	2	(6) full size	9.8	29.0	231/105
MBCB60	60	31	25 1/2	1524	787	648	115	3.0	1/5	2	(6) full size	9.8	33.0	243/110
MBCB72	72	31	25 1/2	1791	787	648	115	3.0	1/5	4	(8) full size	14.3	40.0	309/140
MBCB84	84	31	25 1/2	2115	787	648	115	3.5	3/8	4	(10) full size	17.2	47.0	348/158
MBCB96	96 1/16	31	25 1/2	2438	787	648	115	3.5	3/8	4	(12) full size	21.4	53.0	384/174

\*Height includes casters. \*\*Full size = 20<sup>3</sup>/<sub>4</sub>" x 12<sup>3</sup>/<sub>4</sub>" pans. 1/4 size = 10<sup>3</sup>/<sub>8</sub>" x 6<sup>3</sup>/<sub>8</sub>" pans

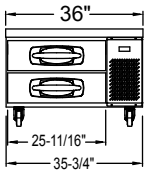

MBCB36 ELEVATION VIEW

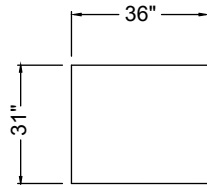

MBCB36 PLAN VIEW

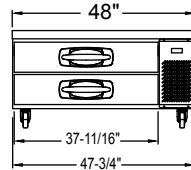

MBCB48 ELEVATION VIEW

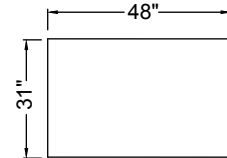

MBCB48 PLAN VIEW

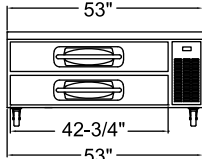

MBCB53 ELEVATION VIEW

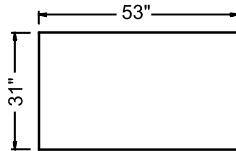

MBCB53 PLAN VIEW

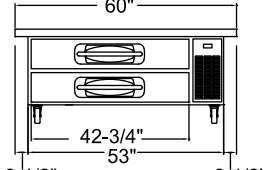

MBCB60 ELEVATION VIEW

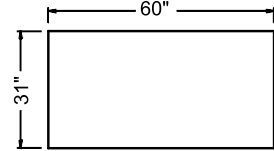

MBCB60 PLAN VIEW

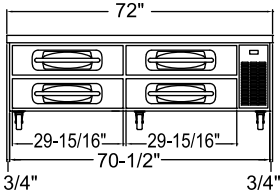

MBCB72 ELEVATION VIEW

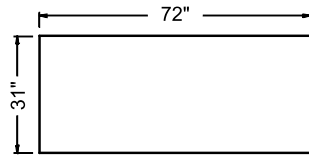

MBCB72 PLAN VIEW

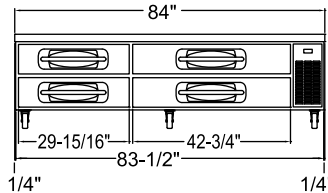

MBCB84 ELEVATION VIEW

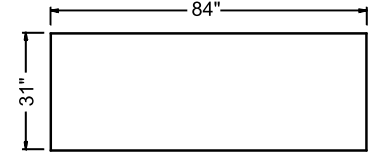

MBCB84 PLAN VIEW

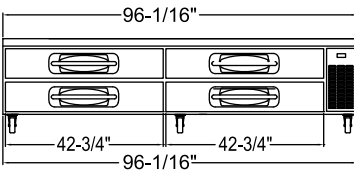

MBCB96 ELEVATION VIEW

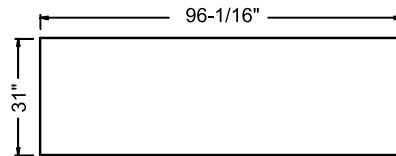

MBCB96 PLAN VIEW

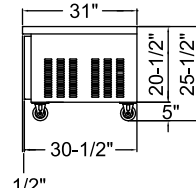

SIDE VIEW - ALL MODELS

### LISTINGS



### HOOKUP

All models via plug in, 9 foot long flexible three wire 14 ga. cord with molded plug.

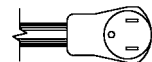

NEMA 5-15P

**NOTE:** Cabinet designed for optimum performance in air-conditioned area at 75°F ambient and 55% relative humidity. All specifications subject to change without notice.