

FOOTPRINT:

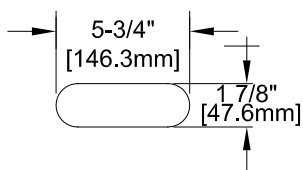

ROUGH-IN:

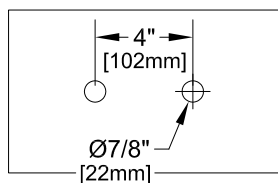

PRODUCT NAME: STAINLESS STEEL
4" DECK MOUNT PRE-RINSE WITH ADD-ON

MODEL:

- 53988 6" SWING SPOUT W/ LEVER HANDLES
- 53996 8" SWING SPOUT W/ LEVER HANDLES
- 54003 10" SWING SPOUT W/ LEVER HANDLES
- 54011 12" SWING SPOUT W/ LEVER HANDLES
- 54038 14" SWING SPOUT W/ LEVER HANDLES
- 54046 16" SWING SPOUT W/ LEVER HANDLES
- 75698 6" SWING SPOUT W/ WRIST HANDLES
- 75701 8" SWING SPOUT W/ WRIST HANDLES
- 75728 10" SWING SPOUT W/ WRIST HANDLES
- 75736 12" SWING SPOUT W/ WRIST HANDLES
- 75744 14" SWING SPOUT W/ WRIST HANDLES
- 75752 16" SWING SPOUT W/ WRIST HANDLES

FEATURES:

CONTROL VALVE

- * 4" DECK MOUNT
- * STAINLESS STEEL CONSTRUCTION
- * SWIVELLING SEAT DISKS
- * HOT SIDE STEM - RIGHT HAND
- * COLD SIDE STEM - LEFT HAND
- * LEVER HANDLES OR WRIST HANDLES

ADD-ON CONTROL VALVE

- * STEM - RIGHT HAND SWIVEL
- * HOT INDEX BUTTON
- * SWIVELLING SEAT DISKS
- * STAINLESS STEEL SEATS, SEAT SCREWS AND HANDLE SCREWS.

HOSE

- * 36" LENGTH
- * STAINLESS STEEL END FITTINGS
- * STAINLESS STEEL EXTERNAL JACKET
- * 3-PLY FIBER REINFORCED INTERNAL RUBBER HOSE
- * REPAIRABLE IN FIELD WITH SIMPLE TOOLS

ULTRA SPRAY VALVE

- * LOWEST ENERGY USER - 1.15 GPM @ 60 PSI
- * CLEANS FASTER - TEST PROVEN
- * ENGINEERED TO LAST - NO 'O' RINGS TO LEAK
- * INTERCHANGEABLE - FITS ALL BRANDS

WALL BRACKET

- * ADJUSTS FROM 2" TO 12"

SYSTEM LIMITS

- * TEMP: 40°F MIN. TO 140°F MAX. STATIC
- * PRESSURE 200 PSI MAX. STATIC
- * SHIPPING WEIGHT: 15.0 LBS

- * NSF 61-9 APPROVED & LISTED
- www.truesdail.com



FISHER MANUFACTURING COMPANY

TOLL FREE: 800-421-6162 - FAX: 800-832-8238

information@fisher-mfg.com - www.fisher-mfg.com