

FOOTPRINT:

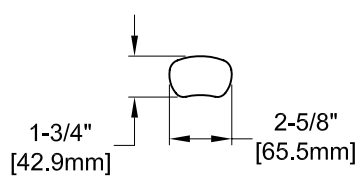

ROUGH-IN:

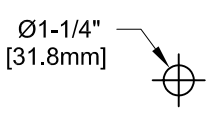

PRODUCT NAME: STAINLESS STEEL
SINGLE DECK DUAL CONTROL PRE-RINSE
WITH ADD-ON

MODEL:

- 53015 6" SWING SPOUT W/ LEVER HANDLES
- 53023 8" SWING SPOUT W/ LEVER HANDLES
- 53031 10" SWING SPOUT W/ LEVER HANDLES
- 53058 12" SWING SPOUT W/ LEVER HANDLES
- 53066 14" SWING SPOUT W/ LEVER HANDLES
- 53074 16" SWING SPOUT W/ LEVER HANDLES
- 76171 6" SWING SPOUT W/ WRIST HANDLES
- 76198 8" SWING SPOUT W/ WRIST HANDLES
- 76201 10" SWING SPOUT W/ WRIST HANDLES
- 76228 12" SWING SPOUT W/ WRIST HANDLES
- 76236 14" SWING SPOUT W/ WRIST HANDLES
- 76244 16" SWING SPOUT W/ WRIST HANDLES

FEATURES:

MAIN CONTROL VALVE

- * SINGLE DECK DUAL CONTROL
- * INTERNAL SPRING LOADED CHECK VALVES
- * SWIVELLING SEAT DISKS
- * HOT SIDE STEM - RIGHT HAND CHECK
- * COLD SIDE STEM - LEFT HAND CHECK
- * STAINLESS STEEL SEATS, SEAT SCREWS AND HANDLE SCREWS

ADD-ON CONTROL VALVE

- * STEM - RIGHT HAND SWIVEL
- * HOT INDEX BUTTON
- * SWIVELLING SEAT DISKS
- * STAINLESS STEEL SEATS, SEAT SCREWS AND HANDLE SCREWS.

HOSE

- * 36" LENGTH
- * STAINLESS STEEL END FITTINGS
- * STAINLESS STEEL EXTERNAL JACKET
- * 3-PLY FIBER REINFORCED INTERNAL RUBBER HOSE
- * REPAIRABLE IN FIELD WITH SIMPLE TOOLS

ULTRA SPRAY VALVE

- * LOWEST ENERGY USER - 1.15 GPM @ 60 PSI
- * CLEANS FASTER - TEST PROVEN
- * ENGINEERED TO LAST - NO 'O' RINGS TO LEAK
- * INTERCHANGEABLE - FITS ALL BRANDS

WALL BRACKET

- * ADJUSTS FROM 2" TO 12"

SYSTEM LIMITS

- * TEMP: 40°F MIN. TO 140°F MAX. STATIC
- * PRESSURE 200 PSI MAX. STATIC
- * SHIPPING WEIGHT: 15.0 LBS

* NSF 61-9 APPROVED & LISTED
www.truesdail.com



FISHER MANUFACTURING COMPANY
TOLL FREE: 800-421-6162 - FAX: 800-832-8238
information@fisher-mfg.com - www.fisher-mfg.com