

APPLICATION:

JOB NAME:

QUANTITY: ITEM NO.

PRODUCT NAME:

SINGLE DECK FAUCET

SPECIAL CONFIGURATION
CHECK BASE MODEL AND OPTIONS

MODEL:

3010 WITH 6" SWING SPOUT

3011 WITH 8" SWING SPOUT

3012 WITH 10" SWING SPOUT

3013 WITH 12" SWING SPOUT

3014 WITH 14" SWING SPOUT

1643 WITH 16" SWING SPOUT

OPTIONS OR MODIFICATIONS:

SUPPLY LINES (24" OR 36") CIRCLE LENGTH

DJ SUB-ASSY (7-1/4" OR 13") CIRCLE LENGTH

HANDLES (CROSS OR WRIST) CIRCLE STYLE

VANDAL RESISTANT KIT

OTHER _____

FEATURES

- CONTROL VALVE**
- * SINGLE DECK MOUNT
 - * SWIVELLING SEAT DISKS
 - * STEM - LEFT HAND
 - * STAINLESS STEEL SEATS
 - * STAINLESS STEEL SEAT SCREWS
 - * STAINLESS STEEL HANDLE SCREWS
 - * HOT AND COLD INDEX BUTTONS

- SYSTEM LIMITS**
- * TEMP: 40°F MIN. TO 140°F MAX.
 - * PRESSURE 200 PSI MAX. STATIC
 - * 2.20 GPM AT 80 PSI

SHIPPING WEIGHT

* 3.0 LBS

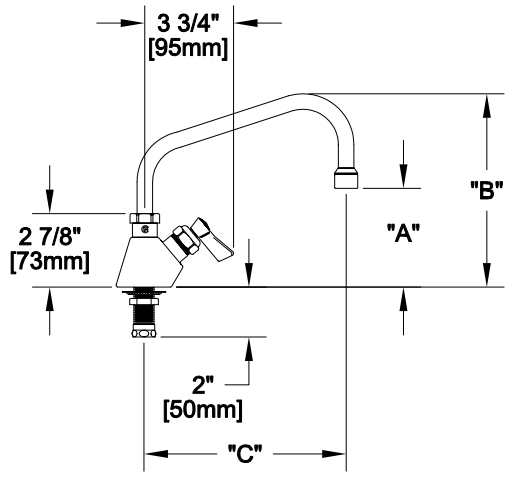

FOOTPRINT:

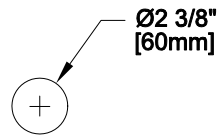

MODEL	DIM "A"	DIM "B"	DIM "C"
3010	3" [75mm]	6 5/8" [168mm]	6" [150mm]
3011	3 1/4" [82mm]	7 1/8" [181mm]	8" [200mm]
3012	3 7/8" [98mm]	7 5/8" [193mm]	10" [250mm]
3013	4 1/2" [114mm]	8 1/8" [206mm]	12" [300mm]
3014	5 1/8" [130mm]	9" [228mm]	14" [350mm]
1643	5 7/8" [149mm]	9 5/8" [244mm]	16" [400mm]

ROUGH-IN:

