

APPLICATION:

PRODUCT NAME:
SINGLE DECK BASE

JOB NAME:

SPECIAL CONFIGURATION
 CHECK BASE MODEL AND OPTIONS

QUANTITY:

ITEM NO.

MODEL:
 3815 W/ 12" SWIVEL GOOSENECK SPOUT
 1929 W/ 6" SWIVEL GOOSENECK SPOUT

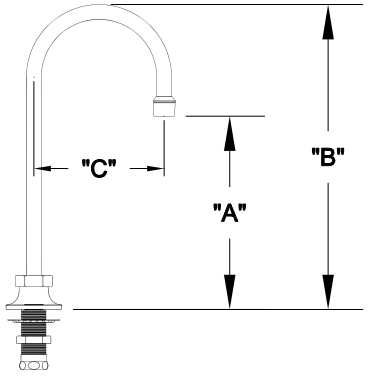

OPTIONS OR MODIFICATIONS:
 SUPPLY LINES (24" OR 36") CIRCLE LENGTH
 NIPPLES
 ELBOWS
 HANDLES (CROSS OR WRIST) CIRCLE STYLE
 VANDAL RESISTANT KIT
 OTHER _____

FEATURES

* SINGLE DECK

SYSTEM LIMITS

- * TEMP: 40°F MIN. TO 140°F MAX.
- * PRESSURE 200 PSI MAX. STATIC
- * 2.20 GPM @ 60 PSI

SHIPPING WEIGHT

* 3.0 LBS

MODEL	DIM "A"	DIM "B"	DIM "C"
3815	8-3/16" [208.0mm]	12-5/16" [312.7mm]	5-1/2" [139.7mm]
1929	4-7/16" [112.7mm]	8-1/16" [204.8mm]	3-1/2" [88.90mm]

ROUGH-IN:

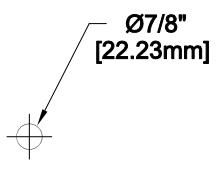

FISHER
 FISHER MANUFACTURING COMPANY
 TOLL FREE: 800-421-6162 - FAX: 800-832-8238
 information@fisher-mfg.com - www.fisher-mfg.com