



PIZZA OVEN BASE



Stand for PIZ6 Oven, Casters, Two Shelves, Stainless Steel Construction



PROJECT _____

ITEM NO. _____

NOTES _____

MODEL NUMBER: **PIZ6B**



CONSTRUCTION

- Stainless Steel Construction
- Heavy Duty Casters for Mobility
- Stainless Steel Shelves for Storage (2)

WARRANTY

- One Year Parts

DRAWINGS

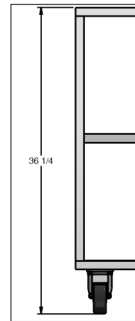

Model	Crated Weight	Overall Dimensions		
		W	D	H
PIZ3B	200 (91)	47" (1194)	35" (889)	36 1/4" (921)



SPECIFICATIONS SUBJECT TO CHANGE WITHOUT NOTICE

KCL & REVIT DRAWINGS UPON REQUEST

REVISION A | 4/21/2021

Follow Us



Doyon

5600 13th Street, Menominee, MI 49858

906.863.4401 | 800.338.9886 | www.doyon.qc.ca

