

# TURBOCHEF (Cont.)

NOTE: All dimensions in inches

## Ovens (Cont.)

Description	Model Use	OEM Number	Order Number
COVER, WAVEGUIDE	NGC, NGC2	NGC-3029	26-5018
DIODE	NGC, NGC2, NGO/Sota, i3, i5	100481	38-1707
DISPLAY	HHB2	HHB-3204	46-1791
ELEMENT, HEATING — Bottom, 208V/3000W	NGC, NGC2	NGC-3003	34-2123
FAN, COOLING — 230V	NGC	NGC-3077	68-1425
FAN/RELAY SOFTWARE UPDATE	NGC, NGC2	NGC-3030-2	44-1776
FILTER, AIR — 6" x 6"	HHC-(1618,2020,2620)	HCT-4067	801-0428
FILTER, AIR — 7 <sup>7</sup> / <sub>8</sub> " x 5"	HHB	HHB-8114	26-5008
FILTER, AIR — 22" x 6"	i3	i3-9039	801-0430
FILTER, GREASE — 9 <sup>3</sup> / <sub>8</sub> " x 7 <sup>1</sup> / <sub>8</sub> "	C3 Oven	TC3-0224	26-5020
FUSE — KTKR-12	i3, i5, HHB(2), NGC(2), C3/D	100592	38-1635
FUSE — KTKR-20	i3, i5, HHC(2020,3240), NGC(2)	100599	38-1188
FUSE HOLDER	HHB	100586	38-1708
GASKET	i5	i5-9331	26-5009
GASKET	NGC	NGC-1308	26-5014
GASKET, DOOR — 19 <sup>1</sup> / <sub>8</sub> " x 9 <sup>9</sup> / <sub>16</sub> "	HHB	HHB-8101.C	800-9515
GASKET, DOOR — 54 <sup>1</sup> / <sub>2</sub> " Long Overall	i3	i3-9309	801-0429
HEATER — Top	NGC, NGC2	NGC-3011	38-1709
HI-LIMIT	HHB, HHB2, HHC-(2020,3240), NGC, NGC2, NGO/Sota, i3, i5	102075	48-1197
HINGE — Left	HHB2, NGC, NGC2	NGC-1572	26-5005
HINGE — Right	HHB2, NGC, NGC2	NGC-1573	26-5004

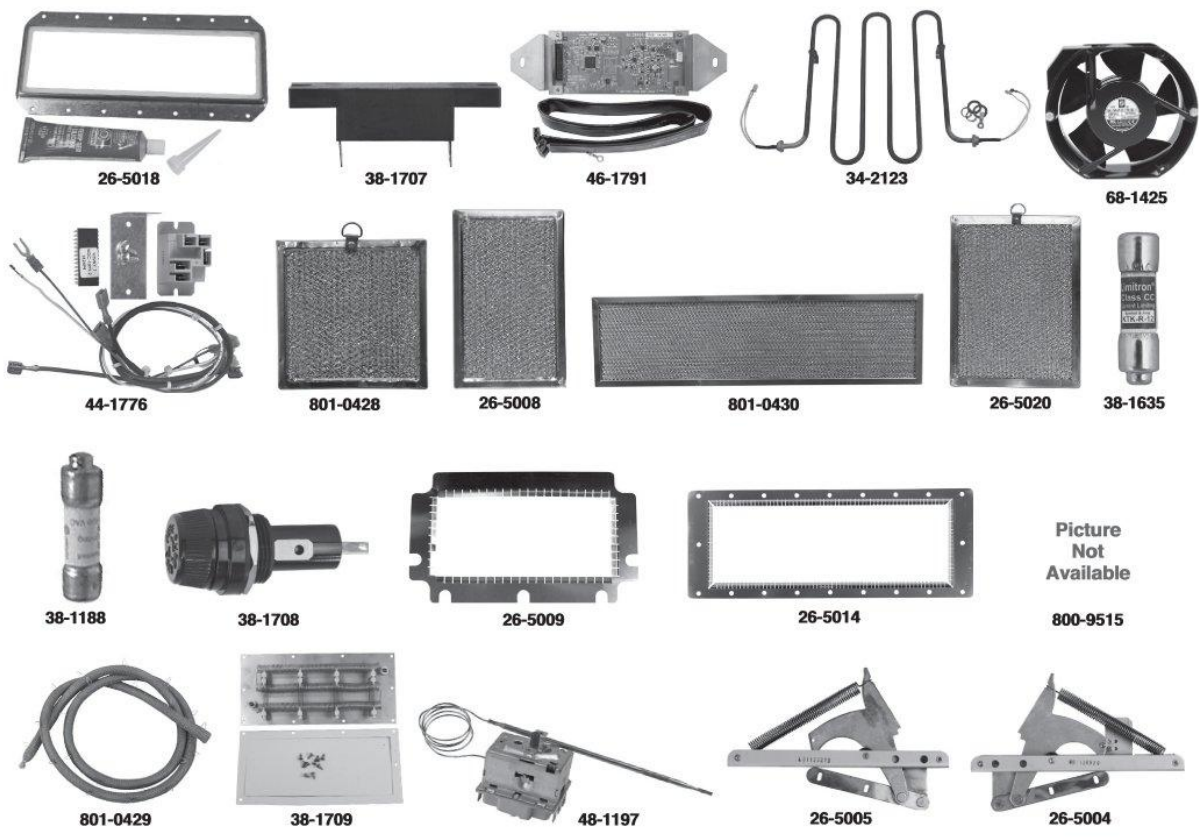

10 REPLACEMENTS BY OEM

# YOUR PARTNER IN PARTS™

## TURBOCHEF (Cont.)

NOTE: All dimensions in inches

### Ovens (Cont.)

Description	Model Use	OEM Number	Order Number
HINGE, DOOR	Convection Oven: HHB	102807	26-5006
KEYPAD — Generic	NGC, NGC2	NGC-1110-1	28-2042
KEYPAD — Subway	NGC, NGC2	NGC-1110-2	28-2043
MAGNETRON KIT	NGC, NGC2, NGO/Sota, i3, i5	NGC-3015	34-2124
MAGNETRON KIT	C3/AB,C3/C,C3/CMulti ED,C3/CMulti EW,C3/CMulti UK,C3/D,C3/D ED,C3/D EW,C3/D UK,C3Multi,D1,D1A,D1B,D2,D2B,D3	TC3-3233	801-0424
MODULE, VOLTAGE SENSE	HHB, HHB2, HHC-2020, NGO/Sota, i3, i5	100783	44-1772
MOTOR, BLOWER — 220/230V	G5, HHC-3240, NGC, NGC-2019, NGC2, i5	100083	801-0427
PADDLE — 13 <sup>5</sup> / <sub>8</sub> " x 12 <sup>3</sup> / <sub>8</sub> "	Where Applicable	NGC-1478	26-5007
PLATE, CERAMIC — 17 <sup>1</sup> / <sub>2</sub> " x 14 <sup>1</sup> / <sub>4</sub> "	C3 Oven	TC3-3214	28-2047
POWER SUPPLY AND BRACKET	NGO/Sota	NGC-3069	46-1797
RACK — 15 <sup>1</sup> / <sub>2</sub> " x 14 <sup>1</sup> / <sub>8</sub> "	NGC, NGC2	NGC-1064-1	26-5010
READER, SMART CARD	HHB, HHB2, HHC-(2020,3240), NGC, NGC2, NGO/Sota	100506	46-1789
RELAY	HHB, HHB2, NGC, NGC2, NGO/Sota, i3, i5	101273	44-1774
RELAY, SOLID STATE	HHB2, HHC-2020, NGC, NGC2	NGC-3005	44-1775
RELAY, SOLID STATE	C3/AB, C3/C, C3/CMulti ED, C3/CMulti EW, C3/CMulti UK, C3/D, C3/D ED, C3/D EW, C3/D UK, C3Multi	TC3-3221	44-1779
RELAY, VOLTAGE	NGC, NGC2, NGO/Sota, i3, i5	101272	44-1773
SCREEN, COOKING — 12" x 12"	Where Applicable	100014	28-2041
SHAFT, STIRRER — 5 <sup>3</sup> / <sub>4</sub> "	Where Applicable	T0289	26-5019
SHUNT ASSEMBLY, DOOR	NGC, NGC2	NGC-3021	26-5017
SOUND DEVICE	HHB2	NGC-3083	38-1710

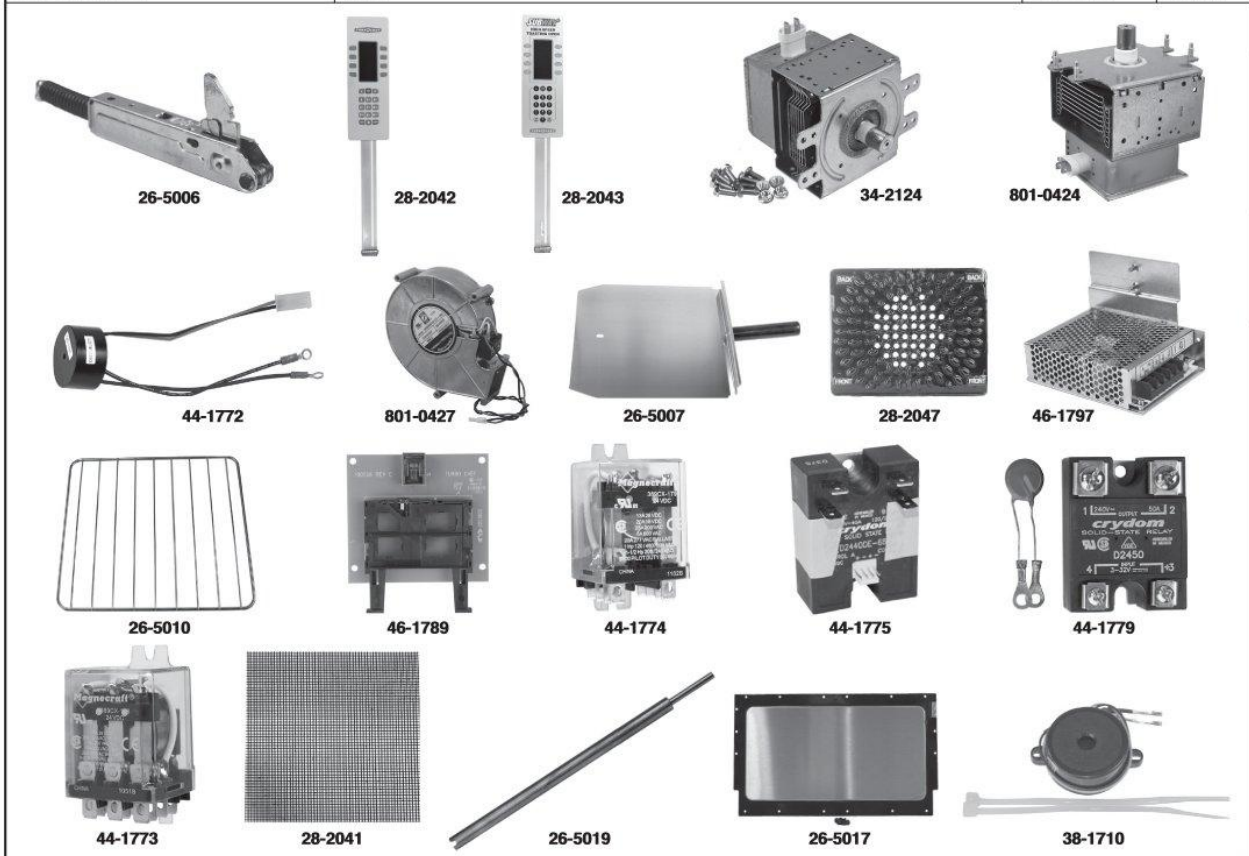

Order Online at: [www.AllPointsFPS.com](http://www.AllPointsFPS.com)

1085

T

10

REPLACEMENTS BY OEM